

# ***cirrus passenger safety briefing card***

## ***#1 seat belts***

- Must be worn at all times.
- To fasten, insert metal tab into buckle.
- To release, lift the flap on the top of the buckle.
- Adjust 4-point harness by pulling down on the buckle and tightening the loose end of the straps. The bottom strap should sit low and tight across your hips.
- Airbags are contained inside the shoulder harness.

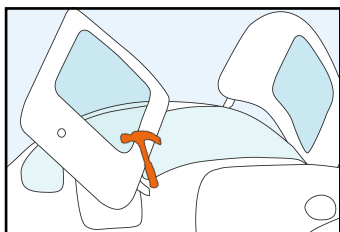
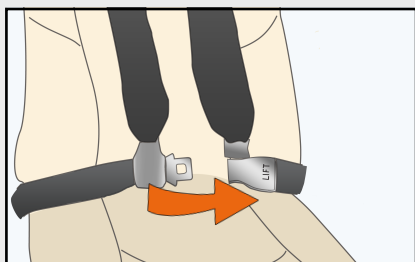

## ***#2 exit or emergency exit***

- Utilize either door. To open, simply lift up on handle.
- In the unlikely event that a door is jammed during an emergency, use the hammer located in the center console to strike the window near the corner, not the center.
- In rare cases, doors may unexpectedly open during takeoff or cruise flight. This is no cause for alarm, though it may be loud.

## ***#3 flight deck***

- This aircraft is equipped with state of the art avionics and safety features.
- Please refrain from touching anything in the cockpit unless instructed by pilot. Front seat passengers should avoid the rudder pedals.
- If you're interested in what's going on, ask during cruise flight. We'll be happy to show you!

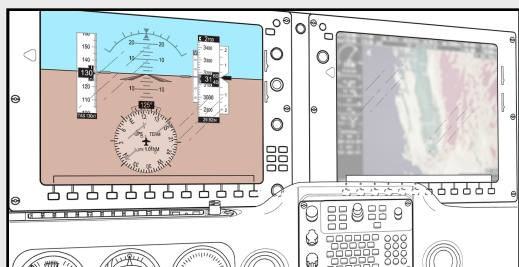

## ***#4 quiet cockpit***

- As a passenger, you can help us improve safety by keeping quiet during take-off and our initial climb and during our descent into our destination and landing. This helps us focus during flight in the sometimes busy airport environment.
- If there's anything related to safety, please do not hesitate to speak up.
- We'll let you know when it's safe to talk again.

## ***#5 airsickness***

- Airsick bags are available in the seat back pockets.
- Air vents are located throughout the aircraft, and can provide both hot or cold air.
- Please let us know as soon as you're feeling ill. We'll do everything we can to make you comfortable.

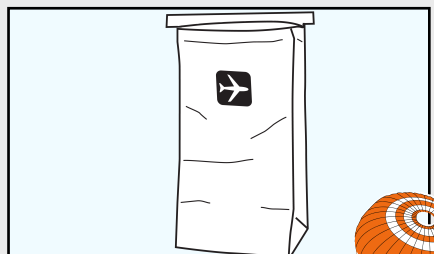

**EMERGENCY INFO ON REVERSE**



# *parachute deployment*

This aircraft is equipped with a whole-plane parachute system. In the event of pilot incapacitation, the parachute should be deployed as quickly as possible.

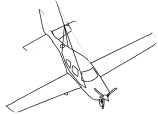

*Just follow these 3 steps:*

## **1** *pull the red handle*

Using two hands, grasp the **red** handle located on the ceiling. Smoothly and firmly pull the handle out, then down. Continue pulling until the parachute deploys. Within 8 seconds, the plane will be level under canopy.

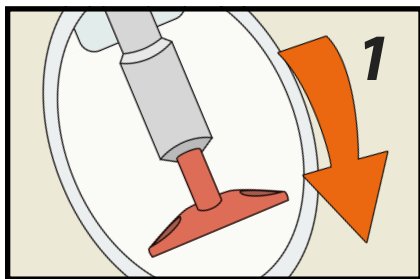

## **2** *cut off fuel flow*

As the chute deploys, pull the **red** mixture lever located between the two front seats all the way back.

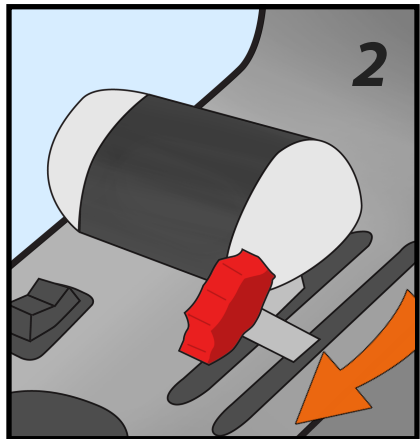

## **3** *brace for impact*

Put your arms at your side and sit upright with your back against the seat.

Do not cross your arms. Exit the aircraft as soon as stopped on the ground.

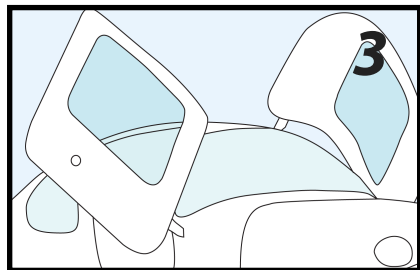

## *any questions?*

feel free to ask before departure

